

This modern refuge on Martha's Vineyard rises from a singular landscape.

By Madeline Bilis
Photos by Michael J. Lee

WHERE the WIND BLOWS

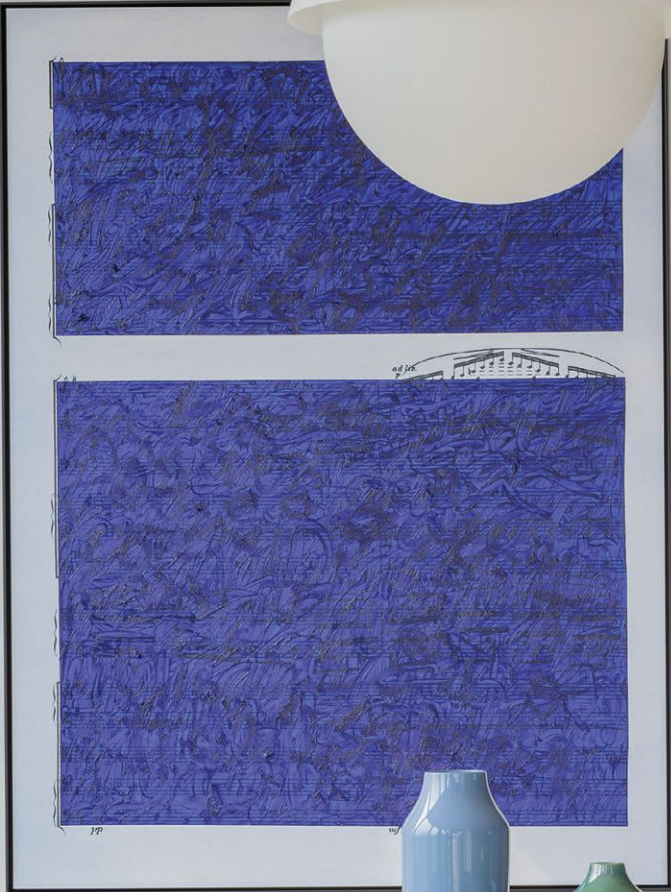



The geometric rug from Warp & Weft compliments the MDF Italia architectural table from Casa Design Group in the breakfast nook.





From top: Contrasting lines from the imposing table by Fern, the Knoll chairs, the Merida rug strike a balance in the dining room; a pop of color in the kitchen.



THE PRIORITY

When the clients bought this pastoral tract of land on the south shore of Martha's Vineyard, it was almost completely untouched. The meadow not only overlooks a pond, high-piled dunes and the sparkling waters of the Atlantic, but it is surrounded by conservation land and distant undeveloped plots. Phil Regan, design partner at Hutker Architects, knew the site could remain undisturbed—and intensely beautiful—with a light touch. His goal was to build an unassumingly stunning abode that sat below the treeline. “We weren’t interested in doing some glorious

house that said, ‘Look at me,’” Regan explains. “We wanted something that was tethered to the natural landscape. And if you went out onto the dunes and looked back, you could barely realize something had been constructed on the property.”

THE CHALLENGE

Without question, the natural beauty of the land would be put on display. But windswept oak trees punctuated the meadow, growing horizontally rather than upward because of the site’s unique exposure. Rather than alter the trees and their extraordinary twisting branches, the team at Hutker resolved to build the house amongst them,

District Eight wood chairs, Alivar metal armchairs and a Living Divani sofa with leather accents sit harmoniously in the living room.





framing exquisite views from each room in the home. To do that, they divided the house into several separate wings, with one comprising public spaces: the kitchen, living room and dining room; one for the primary suite; one for a guest suite; and another with two bedroom suites for the client's sons. A freestanding red barn and a pool house beside the outdoor pool complete the ensemble.

THE DETAILS

The home's color palette takes cues from the native plants and grasses that blanket the landscape, which shift in hue and vibrancy throughout the seasons. "We were able to boil this project down to



The lighting from Bone Simple Design steals the show in the bedroom.

four predominant ingredients: Alaskan Yellow Cedar, walnut, limestone and patinated steel,” explains Tom Shockey, the project’s designer and manager. “They’re all very sophisticated, clean, cool-toned materials. The way the exterior-to-interior experience played with these materials almost takes a backdrop to the changing landscape coloration.”

Inside, the full spectrum of colors, from muted greens and blues to ambers and reds, can be glimpsed in fabrics, furniture, art and accents. A periwinkle wet bar in the living wing and dusty blue tiles in the primary suite’s bathroom nod to the ocean, while sculptural lights dotting the ceiling in the kitchen recall the shoreline.

Another standout feature is the roof deck crowning the primary suite. From there, it’s possible to see both the sun rise in the east and the sun set in the west. “The view from the roof deck is stunning,” says Regan. “It’s undisturbed and there’s no sense of development in any direction.”

THE OUTCOME

The result is a striking home with a remarkably subtle profile, much like the heritage farmhouses of Martha’s Vineyard past. The property reverts the focus to its unparalleled ocean views and one-of-a-kind vegetation. “It’s just a really special place,” Shockey says. “The clean and soft tones of the material really play forward that experience between the art, the architecture and the landscape.”



Views from every room in the house showcase the untamed landscape.

The property's freestanding barn and pool house.





Design Details

Holly Hunt
hollyhunt.com

TYPE
Single-Family

Frederica Furniture
frederica.com

ARCHITECT/INTERIOR DESIGN
Hutker Architects
hutkerarchitects.com

Property Furniture
propertyfurniture.com

BUILDER
J. G. Early
jgemv.com

Tod Von Mertens
todvon.com

LANDSCAPE ARCHITECTURE
Horiuchi and Solien

Walters Wicker
walterswicker.com

CUSTOM MILLWORK
Herrick & White
herrick-white.com

LIGHTING
Allied Maker
alliedmaker.com

FURNITURE
Christian Woo
christianwoo.com

Kaia
kaialighting.com

Bensen
bensen.com

Santa & Cole
usa.santacole.com/en

Casa Design Group
casadesigngroup.com

Adam Otlewski
adamotlewski.com

Design Within Reach
dwr.com

Apparatus
apparatusstudio.com

Fern
fernyc.com

Bone Simple Design
bonesimple.com

District Eight
districteight.com

Articolo
articolostudios.com

Avenue Road
avenue-road.com

RUGS

Warp & Weft
warpandweft.com

Jeff Martin Joinery
jeffmartinjoinery.ca

Merida
meridastudio.com

Showroom Boston
showroomboston.com

Steven King Decorative
Carpets
skcarpets.com